

Bryant Woods Homeowners Association
P.O. Box 1494
Lake Oswego 97035-0550

August 18, 2014

VIA CERTIFIED MAIL

Owner
18439 Deerbrush Ave.
Lake Oswego, OR 97035

RE: Boundary line fence

Dear Homeowner.

Bryant Woods Homeowners Association (BWHA) cares for the common properties associated with the Bryant Woods planned unit development, including approximately 9 acres of green space. A map of our neighborhood including the green space is attached for your information. BWHA shares a property line boundary with your property. BWHA appreciates the many years of good relations with its neighbors and wants to thank you for being a good neighbor.

Periodically the Board of Directors of BWHA inspects the exterior boundaries of the BWHA green spaces. The Board did so in 2010 and is in the process of doing so again. In 2010 the Board wrote to inform you (or your predecessor) that a Record of Survey prepared at the request of BWHA documented that your fence located along the back of your lot extends onto BWHA property.

Recently a Board member observed that the fence remains on the BWHA side of the surveyed boundary. The Board would like to come to an agreement about what will happen when the fence is replaced. In the mean time, the Board hereby grants you a license to maintain your fence on BWHA property and only asks that you please contact us before reconstructing your existing fence or constructing any new structure on BWHA property.

To set up a mutually convenient time to discuss your fence, please contact Board Member Ken Kaufmann, at ken@kkaufmann.com.

Thank you for your time and consideration.

Sincerely,

BWHA Board of Directors, by

its President

BRYANT WOODS HOMEOWNERS ASSOCIATION

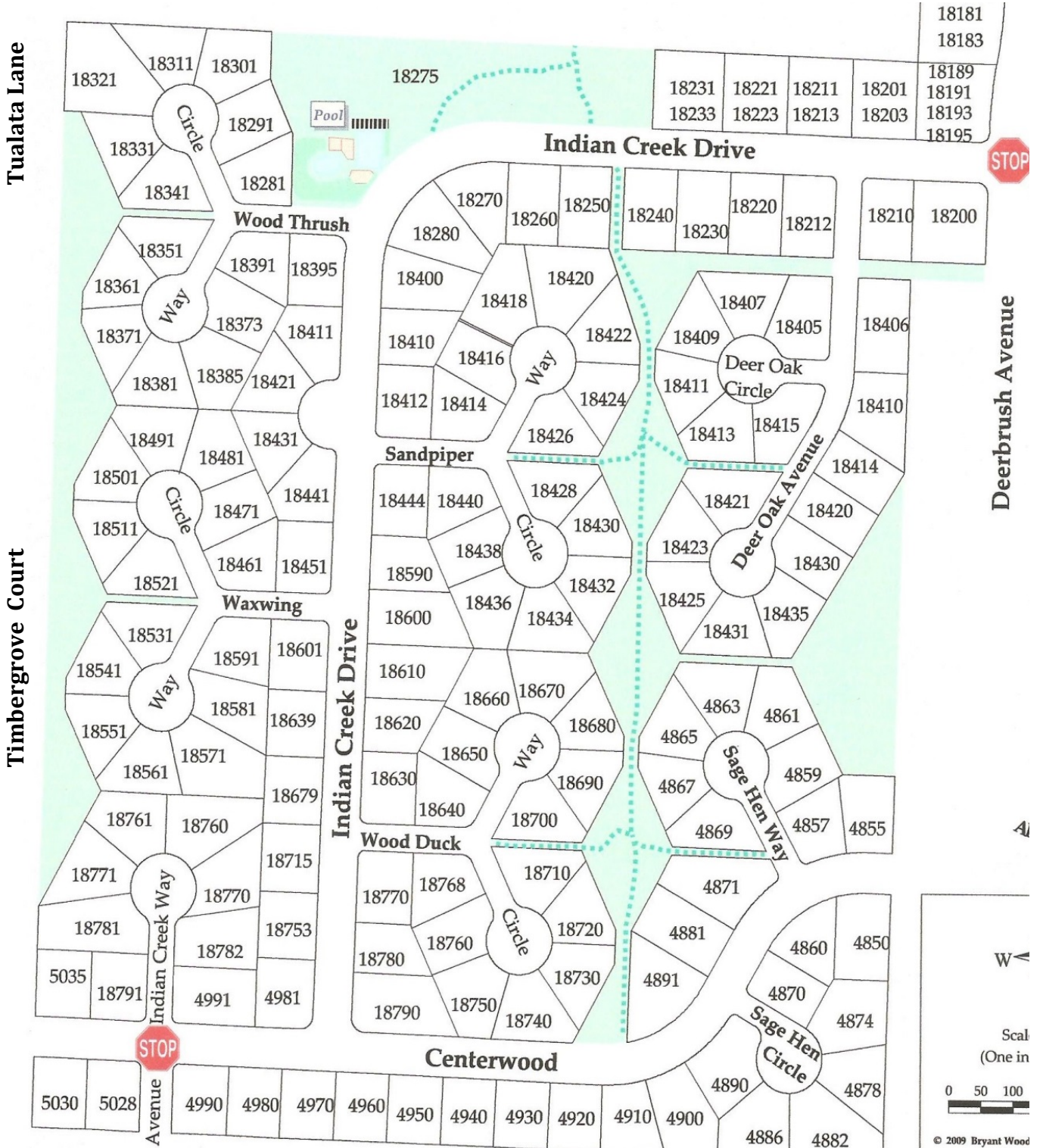

Bryant Woods Homeowners Association
P.O. Box 1494
Lake Oswego 97035-0550

August 18, 2014

VIA CERTIFIED MAIL

Owner
18471 Deerbrush Ave
Lake Oswego, OR 97035

RE: Boundary line fence

Dear Homeowner.

Bryant Woods Homeowners Association (BWHA) cares for the common properties associated with the Bryant Woods planned unit development, including approximately 9 acres of green space. A map of our neighborhood including the green space is attached for your information. BWHA shares a property line boundary with your property. BWHA appreciates the many years of good relations with its neighbors and wants to thank you for being a good neighbor.

Periodically the Board of Directors of BWHA inspects the exterior boundaries of the BWHA green spaces. The Board did so in 2010 and is in the process of doing so again. In 2010 the Board wrote to inform you (or your predecessor) that a Record of Survey prepared at the request of BWHA documented that your fence located along the back of your lot extends onto BWHA property.

Recently a Board member observed that the fence remains on the BWHA side of the surveyed boundary. The Board would like to come to an agreement about what will happen when the fence is replaced. In the mean time, the Board hereby grants you a license to maintain your fence on BWHA property and only asks that you please contact us before reconstructing your existing fence or constructing any new structure on BWHA property.

To set up a mutually convenient time to discuss your fence, please contact Board Member Ken Kaufmann, at ken@kkaufmann.com.

Thank you for your time and consideration.

Sincerely,

BWHA Board of Directors, by

its President

Bryant Woods Homeowners Association
P.O. Box 1494
Lake Oswego 97035-0550

August 18, 2014

VIA CERTIFIED MAIL

Owner
18497 Deerbrush Ave
Lake Oswego, OR 97035

RE: Boundary line fence

Dear Homeowner.

Bryant Woods Homeowners Association (BWHA) cares for the common properties associated with the Bryant Woods planned unit development, including approximately 9 acres of green space. A map of our neighborhood including the green space is attached for your information. BWHA shares a property line boundary with your property. BWHA appreciates the many years of good relations with its neighbors and wants to thank you for being a good neighbor.

Periodically the Board of Directors of BWHA inspects the exterior boundaries of the BWHA green spaces. The Board did so in 2010 and is in the process of doing so again. In 2010 the Board wrote to inform you (or your predecessor) that a Record of Survey prepared at the request of BWHA documented that your fence located along the back of your lot extends onto BWHA property.

Recently a Board member observed that the fence remains on the BWHA side of the surveyed boundary. The Board would like to come to an agreement about what will happen when the fence is replaced. In the mean time, the Board hereby grants you a license to maintain your fence on BWHA property and only asks that you please contact us before reconstructing your existing fence or constructing any new structure on BWHA property.

To set up a mutually convenient time to discuss your fence, please contact Board Member Ken Kaufmann, at ken@kkaufmann.com.

Thank you for your time and consideration.

Sincerely,

BWHA Board of Directors, by

its President

BRYANT WOODS HOMEOWNERS ASSOCIATION

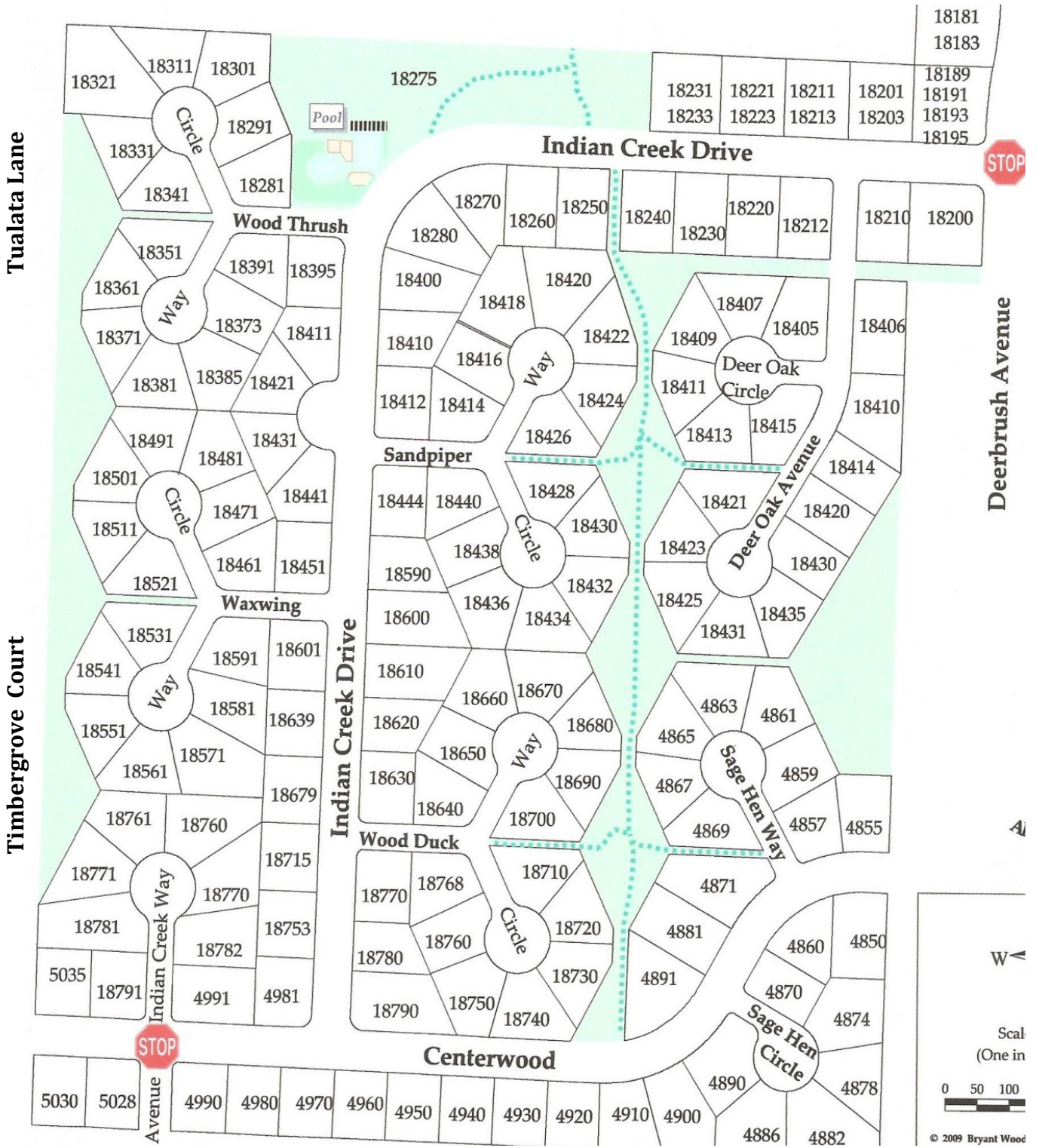

W ←

Scale
(One in

0 50 100

© 2009 Bryant Wood

Letter re (East side) Boundary line fence to be mailed, certified mail, to the following addresses:

Last known Owner name (2010)	Address	Status
Owner	18439 Deerbrush Ave.	North; 2' wire fence and shed
Owner	18471 Deerbrush Ave	Middle; 3' wooden fence in two courses
Owner	18497 Deerbrush Ave	South; 4' wire fence